

# Girraween



## PRIMARY SCHOOL

25 CARRUTH ROAD  
admin.girrasch@ntschoos.net

GIRRAWEEEN NT 0836  
<http://www.girraweenprimary.nt.edu.au/>

PH: (08) 8983 3300  
Facebook: Girraween Primary School



# Girraween School Logo and Motto



At Girraween the whole child is valued and we promote social, emotional, academic and physical development.

Our logo takes the form of an acacia tree, which is common to our area and has a pathway leading to it. It says that along our learning pathway there will be many choices to make or branches to take in order to achieve. Our Motto 'Rising to the Challenge', supports our logo by recognising that there will be many different challenges to face and that no matter the challenge, we will grow and the solid trunk of our learning will support us.

The school has a set of clearly defined core values called 'Seeds of Success'. These values are what the school community believe are important for successful learning and living. They are:

Responsibility Personal Best Fairness Respect Care



## NOTES



# Girraween School Map

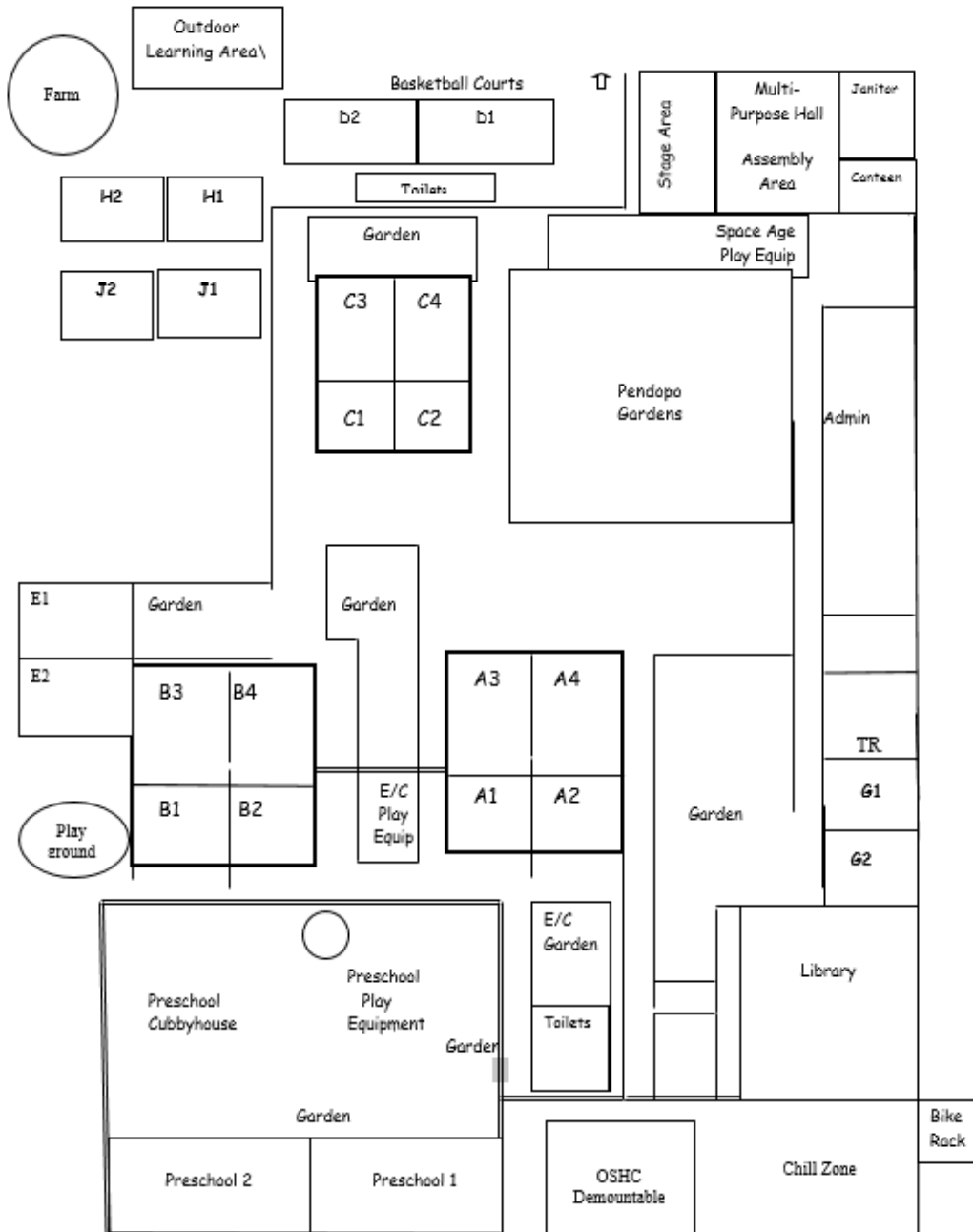

# Getting Along at Girraween School

We use our school values as the basis for our behaviour management processes. Students are explicitly taught how to follow the values: Respect, Fairness, Personal Best, Responsibility and Care.

We also expect adults in our environment to follow these values when interacting with our students, staff and parents.

If we follow these values, we all get along and can focus on our learning. We are also very aware that our children are still learning how to navigate their world, how to work and play together harmoniously and to make good choices. Children need support to further develop their social and behavioural skills at different times.

We recognise positive behaviour through:

- Merit Awards– class and school
- Stickers towards goals
- Class Raffles
- Class games and treats e.g. a picnic lunch
- Dojo points

When a problem arises we use a restorative justice process to come to a solution. This includes everyone who is involved sitting down and having a conversation. The following questions guide the conversation:

1. What happened?
2. What were you thinking of at the time?
3. What have you thought about since?
4. Who has been affected by what you have done? In what way?
5. What do you think you need to do to make things right?

We use a variety of consequences including:

1. Time to think/ break time in the classroom or the buddy class
2. Community service
3. Walking with the teacher on duty
4. Chill Zone– to either participate in a restorative conversation or to have some time away from the playground.
5. Time Out At Lunch (TOAL)– withdrawal from the playground and reflective activity.
6. Behaviour Plans
7. Natural consequences, e.g. scribbling on a table– cleaning the table.
8. Limiting the play area to a specific space

When a behaviour plan is deemed necessary to help a child to self manage, parents are involved in the development of the plan.

# Girraween Primary Helpful Information

## Nut Aware School

Within our school community we have children with severe food allergies. The most common of these is the allergy to nuts which can be life threatening.

Girraween Primary School has a nut aware policy and it is essential this policy is implemented. Please do not send your child to school with any nuts or nut products. Exposure is hard to avoid and even trace amounts can trigger symptoms. If a product has 'may contain traces of nuts' on the packaging, this is suitable for school.



## Healthy Food at School

We recommend that children bring healthy food to school that fuel their bodies and minds for learning. We recommend that treat food such as lollies, chips and high sugar bars are kept for home. Teachers will remind children to eat their high nutrient food first.

## Canteen

Our canteen is managed as a private business. The menu is available in the front office. It is also available on the website and the school bag app. You can order on line at: <https://www.ouronlinecanteen.com.au/> Please make sure you update your child's class to ensure they receive their lunch.

## Resource Pack

Each student is encouraged to purchase a resource pack which covers:  
**Subscriptions**  
 Reading Eggs, Matific & typing tournament.  
**Performance - x1 (incursion)**  
**Stationary consumables for the year**

## Voluntary Contributions

Parents are invited to contribute a levy which goes towards:

- First aid supplies
- Ambulance subscriptions
- Technology resources
- Library resources
- Sports equipment

## Our Uniform

Tops	Ochre Shirt or school sports shirt on sports day.
Bottoms	Navy shorts, skirts or skorts
Feet	Sneakers or sandals with a back strap.
Heads	Bucket Hat
Ears	Sleepers or studs- no dangling earrings.
Jewellery	<i>Is limited to avoid accidents on the playground or during sport</i> Watch, Necklace which can be worn under the t-shirt. Girraween wristbands

# Reporting Planner

## Informal reporting

Classroom Letters are sent to parents informing them of the learning that will take place across the term, important dates etc.

A letter to parents of students participating in specific support programs across the semester including: literacy intervention, social and emotional groups, enrichment programs etc.

Whole school newsletter announcing achievements and recognising students progress and merit.

## Ongoing Whole School Informal Reporting

Reminder: Teachers are not able to discuss children during school hours as their main focus is on teaching. Please make an appointment if you need to have a conversation with the teacher. During the school day, teachers may not be able to respond to emails. If a matter is urgent please send a message through to the front office.

- Merit Certificates
- Informal correspondence with parents - email/phone
- Certificates from competitions
- In-class rewards
- Recognition of achievement in newsletter
- Letters to inform inclusion programs or extension and enrichment programs



# Reporting Planner

## At Girraween School:

- Parents and Teachers are stakeholders in the child's education and as such, regular contact between parents and teachers is actively encouraged for the ongoing success of the child
- Teachers contact parents where there is a concern with academic or social development, where issues arise or there is an ongoing issue that needs to be discussed
- Parents are encouraged to meet with the teacher if they have concerns about their child's progress in the first instance
- Students are assessment capable learners and a valuable part of the reporting process, and as such need to play a leading role in three way conferences

## Formal Reporting

### TERM 1

**Parent-Teacher Interviews involve the teacher and parent, and possibly the student. During the Interview, everyone has a role to play.**

**Parents** – raise any concerns they have about their child and help make plans to support their child's learning at home.

**Teachers** – inform parents or current reality referring to student data collected and beginning of the year samples of work, share student goals they will be working towards in English, Maths and Learning Disposition.

**Students** – co-construct goals with the teacher that they will be working on during class time, make choices about artefacts they would like to share with their parents at the interview.

### TERM 2

Formal A to E reports to Parents (grades 1-6)

Students with special needs receive an EAP report (with or without grades determined by parents)

Formal Transition Reports to Parents

Preschool Reports and Portfolios are sent home (to be returned)

### TERM 3

**3-Way conferences involve the teacher, parent and student. During the 3-Way conferences, everyone has a role to play.**

**Students** - demonstrate what they know as they share their accomplishments through their evidence of learning portfolio and set new learning goals.

**Parents**- find out about their children's learning, have the opportunity to ask questions and express their ideas, and help make plans to support their children's learning at home.

**Teachers**- facilitate the three-way conversations. They support the learners and the parents by clarifying, elaborating and responding to specific questions and concerns.

Student **Evidence of learning portfolios** are sent home post the 3-Way conference (grades 3-6)

Parents will receive **NAPLAN** results for students Years 3 and 5.

### TERM 4

Formal A to E reports to Parents (grades 1-6)

Students with special needs receive an EAP report (with or without grades determined by parents)

Formal Transition Reports to Parents

Preschool Reports and Portfolios are sent home

**Student Evidence of learning portfolios** are sent home (grades T-2)

## Special Education Students:

Classroom teacher, special education teacher and parents will meet to formalise and adjust student learning plans (EAP, IBP, SSP).

# Girraween Primary Helpful Information

## School Times

8:15 Music Plays– move to the classroom

8:20 School Commences

10:20 Recess

10:50 Lessons resume

12:40 Students eat lunch with their class  
(Early childhood start a bit earlier.)

12:50 Lunch Play

1:20 Lessons resume

2:40 Home Time

## Electronic Equipment

Students are not permitted to use their phones or other technology at school. Each class has a message bag and devices are placed in the message bag and are kept in the office for safe keeping. While we put in place processes to care for this equipment, it is important that parents are aware that we do not take responsibility for any loss or damage that may occur.

## Assemblies

We hold whole school assemblies on Friday of every fortnight in even weeks. Classes take turns to host and perform at assemblies. Parents are welcome to join us.

## Preschool Times

Monday and Tuesday 8:30-2:30

Alternate Wednesdays 8:30-2:30

Our Monday and Tuesday groups attend the Wednesday in the odd weeks of the term.

Our Thursday and Friday groups attend the Wednesday in the even weeks of the term.

## Wet Weather

If there is a lightning storm at home time, the students will wait in their classrooms to be collected by an adult. We will load buses if it is safe. Please discuss with your child how they should get home from the bus stop if there is a storm.

## Zoning / Managed Environment

As our school has grown rapidly, the Department of Education have implemented the managed enrollment process. **This means we can only accept students from our feeder zone.** Proof of residence must be provided before an enrolment can be processed.

# Girraween Primary Helpful Information

## Outside School Hours Care

We run before school, after school and vacation programs. For more information or to enrol your child please contact our director: [jennifer.heinrich@ntschoos.net](mailto:jennifer.heinrich@ntschoos.net) or phone: (08)8983 2499



## School of Music

We work with the school of music to provide instrumental lessons for students in years 5 and 6.



Students in this age group can also join the BEAT choir who work towards performing at the Darwin Entertainment Centre in September.

<https://www.ntms.net.au/enrolment-form-2020>

## School Chaplain

Our school chaplain provides pastoral care for our students and families. Ester Pena is our chaplain and she is at the school on Wednesday and Friday. At lunch times on these days 'Kids Club' is open, kids can hang out and participate in a variety of activities. Small groups to help children work on specific issues, e.g. friendship, dealing with grief, anxiety are organised on a needs basis. Each year, parents receive a note to give permission for their child to participate in programs run by the Chaplain. If you or your child's teacher feel your child will benefit from an individual or small group program, you will be asked to give written permission on top of the general permissions.

## School Counsellor

We have access to a school counsellor through the Department of Education. The counsellor works with children on a one-to-one or small group basis where the parents and teachers feel this would be of benefit. Normally the counsellor only sees a child for 5-6 sessions and then refers to external agencies if the need for support continues.

# Teaching and Learning

Our teachers work in teams to collaboratively plan using the Australian Curriculum. This ensures students in the same year level have consistency in their learning. You can view the Australian Curriculum at: <http://www.acara.edu.au/curriculum> Student progress is assessed to the achievement standards and support and extension is provided as required.

## Tiers of student support

### Tier one

Students participate in quality class programs which cover all areas of the Australian Curriculum. Teachers provide extension for students who have grasped the concepts being covered.

Students are given opportunities for extension through REACh program, Aust wide competitions, electives.

Students who are formally identified as gifted have a student support plan.

### Tier two

Students requiring additional support are catered for in the classroom, small group or individual situations. This may cover numeracy or literacy intervention.

### Tier three

Levelled Literacy Intervention is a small group program to help boost a students' reading. Speech, OT, and social and emotional programs are in place for some children. Number Crunch - Small group math

### Tier four

Students who have identified disabilities or learning needs have support plans or Educational Adjustment Plans which are overseen by our special needs teachers.



# Girraween Primary Learning Powers

# Getting Involved at Girraween

I take on different roles effectively negotiating, sharing and working with others to achieve group goals.



GIRRAWEEEN LEARNING POWERS  
**CAPTAIN COLLABORATIVE**

I am resilient, responsible, responsive and reflective. I set goals and learn independently and in groups.



GIRRAWEEEN LEARNING POWERS  
**CAPTAIN COMMITTED**

I imagine possibilities and connect ideas by thinking logically, creatively and reflectively whilst showing persistence and flexibility.



GIRRAWEEEN LEARNING POWERS  
**CAPTAIN CREATIVE**

I question, investigate and critically examine information to guide my decision making and share information with others.



GIRRAWEEEN LEARNING POWERS  
**CAPTAIN CURIOUS**

- **Working Bees:** normally held once a term to keep our farm and grounds looking great. Pictures are published via social media.
- **Craft Group:** meets regularly to make and package gifts for our Mother's Day, Father's Day and Christmas stalls.
- **Class programs:** teachers will let you know how you can support their programs.
- **Whole School Events:** Movie Night, Field Day, Sports Carnival, Dance Night. Watch the newsletters for calls for help to organise these events.
- **Farm Programs:** we appreciate any support on the farm. When the animals return we will call for volunteers to feed them on the weekends.
- **Library Helper:** covering books, tidying shelves. Please contact Ms Chaffey in the library or the administration team in the front office.
- Parents can assist in their own child's class under teacher supervision without an ochre card however, parents are encouraged to obtain a volunteer ochre card. This is essential if you want to attend excursions, sleepovers or camps. <https://forms.pfes.nt.gov.au/safent/>



GET   
**ON BOARD**

# Girraween Primary Helpful Information

## Attendance

Students are required to attend school every day.

If your child is unwell and not able to attend it is very important that the school is notified. You can inform the school of absences by:

- Lodging the absence on the website or through the school bag app.
- Emailing [admin.girrasch@nts.schools.net](mailto:admin.girrasch@nts.schools.net)
- Phoning 89833300

If a student has five or more unexplained absences in a five week period, the principal is required to notify the truancy officer.

If parents plan a holiday during the school term, written notification is required to be sent to the principal. If notification is not received, the student will be recorded as un-notified or an unacceptable reason which would attract the attention of the truancy officer. Work contracts can be provided for such absences.

Our school funding is linked to attendance, please support us by notifying us of all absences.

When your child misses just:	That equals:	Which is:	And therefore, from preschool to year 12, that is:	This means that the best your child can achieve is:
1 day each fortnight	20 days per year	4 weeks per year	Nearly 1 1/2 years of school	Equal to finishing year 11
1 day a week	40 days per year	8 weeks per year	Over 2 1/2 years of school	Equal to finishing year 10
2 days a week	80 days per year	16 weeks per year	Over 5 years of learning	Equal to finishing year 7
3 days a week	120 days per year	24 weeks per year	Nearly 8 years of learning	Equal to finishing year 4

## Late

Lessons commence at 8:20 each morning. It is very important that all students are at school on time so they do not miss valuable lessons. When children arrive after all of their peers, they often take longer to settle. They could potentially miss the same lesson every day which creates gaps in their overall learning. If your child is late, you need to sign him/her in at the office and will need to collect a late slip so our records are accurate.



School success starts  
with attendance

### PLEASE NOTE

If a student is absent for more than three days, a medical certificate must be provided.

# Specialist Activities at Girraween



## Specialist Activities for the 0-4 age range

### Playgroup

Our Playgroup meet every Wednesday from 8:30 in the outside kitchen area beside the pre-school. Come along and meet other parents as your child/ren enjoy playing in our beautiful school grounds.

### Songs and Stories for Littlies

At Girraween school, we recognise the value of words and music for everyone. Long before school age, we support and stimulate development of thinking, communication and movement skills in our children through songs and stories. On Thursdays at 8:30 parents and little ones can join the group in the library for stories and songs. After the music session, tea and coffee will be available in the external kitchen area.

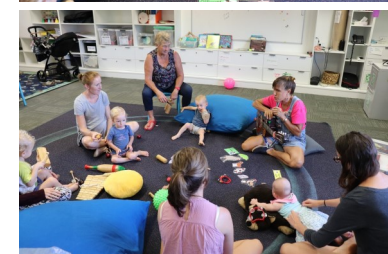



# Girraween Primary Helpful Information

- **Maths Competition:** Each year in Term 3, students from years 3-6 are encouraged to participate in the Australian Mathematics Competition. Interested students receive lead up workshops with a teacher to practise their maths proficiencies (problem solving, understanding, fluency and reasoning) under the competition conditions. Students have the opportunity to take home practice questions in preparation for the challenge. Girraween are very proud of their growing body of students who partake and achieve in this competition.
- **Writing Competitions:** Throughout the year Girraween teachers take every opportunity to partake in writing competitions. This includes the Red Room Poetry Competition, Palmerston Young Writers, Write Us In and more. These competitions give students a sense of purpose in their writing and the opportunity to see themselves as authors of work, leading to published work.
- **Reading Challenge:** Over the three week break in June/July, Girraween hold a reading challenge across the school. Each class is encouraged to read as much as possible, with the winning class receiving prizes for their classroom. Our library is open on set days to support the borrowing of quality literature. This Challenge recognises the importance of ongoing reading where research shows, just ten minutes a day makes a huge difference.
- **PMP:** Students in transition participate in a perceptual motor program twice weekly in the dry season that works to develop their gross motor and perceptual language. Parent help is required to successfully run this program. If you are available, please let your teacher know
- **Excursions/Camps/Outdoor Education:** In support of our curriculum focus teachers take children on trips outside the school environment. Each excursion requires parents to complete and sign a permission form, and there may be a cost involved. Students in years 4-6 will have the opportunity to attend external camps throughout the year. The year 3 students will also get the chance to have a sleepover at the school
- **Swimming:** At Girraween we offer swimming lessons in Term 4 (Week 7 and 8) through Royal Life Swim and Survive NT. Places are offered on a first come, first serve basis and run for 8 days (4 days across a fortnight). In these lessons students learn swimming skills which are developmentally appropriate. Students staying at school during this time participate in health lessons including water safety.
- **Buddy Partnerships:** As part of our whole school approach, early year and primary year classes buddy up in an effort to build social connections across the school. This partnership is timetabled and programed for students to work peer-to-peer in an area of learning based on the needs and interests of the students involved facilitated by the co-teachers of the buddy classes.

# Girraween Primary Helpful Information

## Morning Playground Supervision

In the mornings we commence playground supervision at 8 a.m. Whilst teachers are often at school working, they are not responsible for the students who arrive too early. We have a before hours school care program if you need to drop your child off earlier than 8 a.m.

## After School Supervision

At the end of the day, we have staff on duty in 4 areas to supervise students as they leave school: bus area, drop off zone and the school crossing. Please support us by using the crossings and teaching children to follow the road rules. If parents are in the school grounds after hours with their children, they are responsible for the behaviour of the children and it is an expectation that the children follow the school rules.



## School Banking

Girraween Primary are involved in the Commonwealth Bank's School Banking Program. If your child would like to get involved in the School Banking Program and don't have a Youth Saver Account, there are two simple ways for you to open one:

### Online

Visit [commbank.com.au/schoolbanking](http://commbank.com.au/schoolbanking) and click on the link to open the Youth Saver Account

### OR

**In branch** - Visit any Commonwealth Bank branch and staff will assist.

Parents will need to bring along identification for themselves and their child, like their Driver license and child's birth certificate. Accounts can be opened from a mobile, tablet or desktop device so parents will have the flexibility of opening the account on the spot at School Banking Information Sessions or from home at their own leisure. For all new accounts opened online where they have selected to participate in School Banking, a School Banking welcome pack will be mailed to their home address, including a Dollarmites deposit wallet and book.



# Girraween Primary Helpful Information

## Specialist Programs

Students from transition to year 6 participate in specialist programs such as:

- Physical Education
- Performing Arts
- Library and Media Arts
- Japanese
- Our World

These programs are taken by our specialist teachers and give students the opportunity to develop their skills and knowledge in other key learning areas. These classes are attended once a week while the classroom teacher has their required preparation time.

Other programs your child may participate in are:

- **Rock and Water:** a program run across the school that builds self-awareness, self-regulation and confidence to manage playground and class behaviour. This is achieved through games and discussions
- **Healthy Harold:** every second year Life Ed visit Girraween and host lessons across the school around health and well-being.
- **St Johns First Aid:** each year students participate in learning about first aid at their developmental level through visits from St Johns
- **Musica Viva (Term 2):** Each year there is a focus on music from a different country. Students learn a repertoire of songs and build their knowledge and understanding of that country's culture. The performance culminates the learning sequence and involves student participation
- **Drumbeat**



# Girraween Primary Helpful Information

## • Choirs

Our year 3/4 students can join the **junior choir**.

**BEAT** is a choir program for our year 5 and 6 students to participate in. They practice Terms 1 and 2 with a performance at the Darwin Entertainment Centre in Term 3. This is a program run across all Darwin, Katherine and Alice Springs Schools. Cluster rehearsals give students the opportunity to meet other BEAT students.

- **Sport:** Students at Girraween have the opportunity to represent their region in various sports including soccer, basketball and athletics. Students participate in 'gala days' run during school time and from there have the opportunity to attend selection trials out of school hours. Girraween offers extra curricula (out of school hours) sports that vary from term to term and align with the Australian Curriculum. This is another way that interested students from grades 1-6 can improve in their fundamental movement skills, social skills, game sense and confidence. This is organised by our PE Teacher.

- **REACH (Rural Enrichment Achievement Challenge):** Each term students from years 3-6 are selected to participate in an enrichment challenge centred around the key learnings of the curriculum. The challenge is hosted in one of our rural hub schools, decided at the beginning of each year. In the past, we have had debating, maths, STEM, Sustainability and dance challenges. Students are selected through a merit based process where all classroom and whole school assessments are considered. The students participate in lead up lessons with a teacher to prepare for the challenge which is modelled on the Renzulli's three rings of giftedness to ensure students are building their task commitment and creativity alongside their above average ability. This is a strengths based approach where students have the opportunity to enrich an area of learning that they are talented in.

